

- You may photocopy this sheet and use it as an order form.
- Sie können dieses Blatt kopieren und als Bestellformular verwenden.
- Vous pouvez photocopier cette feuille et l'utiliser comme bon de commande.
- Dit blad kan gecopieerd en als bestelformulier gebruikt worden.
- Potete fotocopiare questo foglio e usarlo come modulo di commissione.

SHIMANO DEORE Front Chainwheel (Silver Version)

Nov. 1999

FC-M510-s

FC-M510-SK For Chain Case

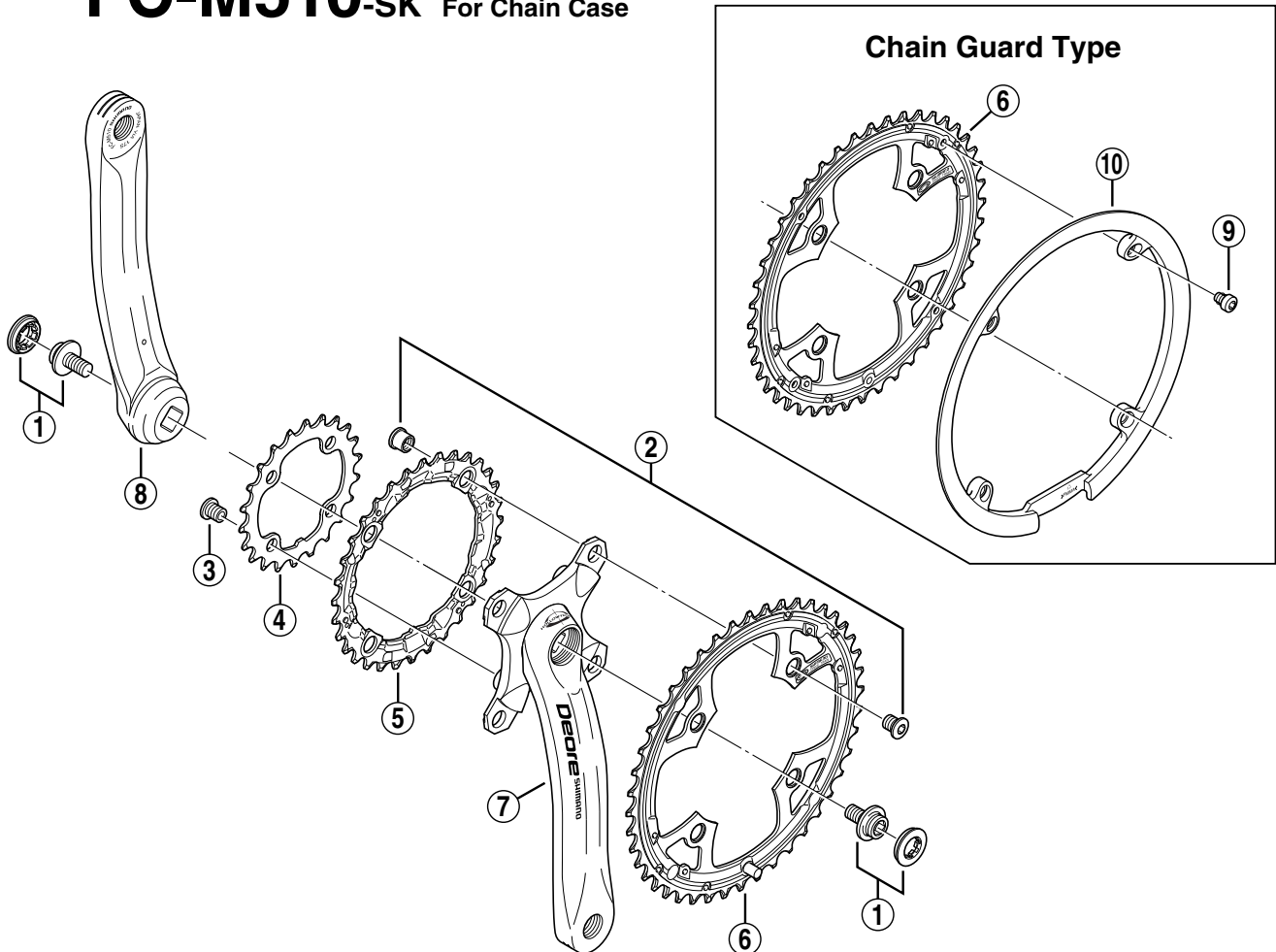

- Chaining teeth combinations: 44 - 32 - 22T / 48 - 36 - 26T
- Bolt circle diameter: 104 mm...(For outer gear and middle gear), 64 mm...(For inner gear)

ITEM NO.	SHIMANO CODE NO.	DESCRIPTION
1	Y-16M90100	Crank Arm Fixing Bolt & Cap
2	Y-1C8 98010	Double Gear Fixing Bolt (M8 x 8.5) & Nut (4 sets)
3	Y-1BD98030	Inner Gear Fixing Bolt (M8 x 8.5 / 4 pcs.)
* 4	Y-1DJ 22100	Chaining 22T (Silver)
	Y-1DS26000	Chaining 26T (Silver)
	Y-1DS98010	Chaining 32T (Silver)
* 5	Y-1DS98200	Chaining 36T (Silver)
	Y-1DS98020	Chaining 44T (Silver)
	Y-1DS98030	Chaining 44T (Silver) for FC-M510-SK
	Y-1DS98040	Chaining 44T (Silver) for Chain Guard
* 6	Y-1DS98210	Chaining 48T (Silver)
*	Y-1DS98220	Chaining 48T (Silver) for FC-M510-SK
*	Y-1DS98230	Chaining 48T (Silver) for Chain Guard
	Y-1DS98050	Right Hand Crank Arm 170 mm (Silver)
	Y-1DS98060	Right Hand Crank Arm 170 mm (Silver) for FC-M510-SK
	Y-1DS98070	Right Hand Crank Arm 175 mm (Silver)
	Y-1DS98080	Right Hand Crank Arm 175 mm (Silver) for FC-M510-SK
	Y-1DS98090	Left Hand Crank Arm 170 mm (Silver)
	Y-1DS98100	Left Hand Crank Arm 175 mm (Silver)
9	Y-1CY98020	Chain Guard Fixing Bolt (4 pcs.)
	Y-1C6 18000	Chain Guard (for 44T)
* 10	Y-1DS08000	Chain Guard (for 48T)